



# Potrero Center

2300 16th Street | San Francisco, California

## NOW LEASING

SPACE #	SF	RENT	NNN
1655	3,890	Call	\$11.05

For information, contact:

**Courtney Jones**, CA DRE #01232209  
[cjones@crosspointrealty.com](mailto:cjones@crosspointrealty.com)

**Carter Hemming**, CA DRE #01123464  
[chemming@crosspointrealty.com](mailto:chemming@crosspointrealty.com)

Phone: 415.288.6888

Fax: 415.288.6877

Crosspoint Realty Services, Inc.  
260 California Street, 4th Floor  
San Francisco, CA 94111  
[www.crosspointrealty.com](http://www.crosspointrealty.com)



## SITE PLAN - UPPER LEVEL

Contact: Courtney Jones (CA DRE #01232209), [cjones@crosspointrealty.com](mailto:cjones@crosspointrealty.com) Carter Hemming (CA DRE #01123464), [chemming@crosspointrealty.com](mailto:chemming@crosspointrealty.com)

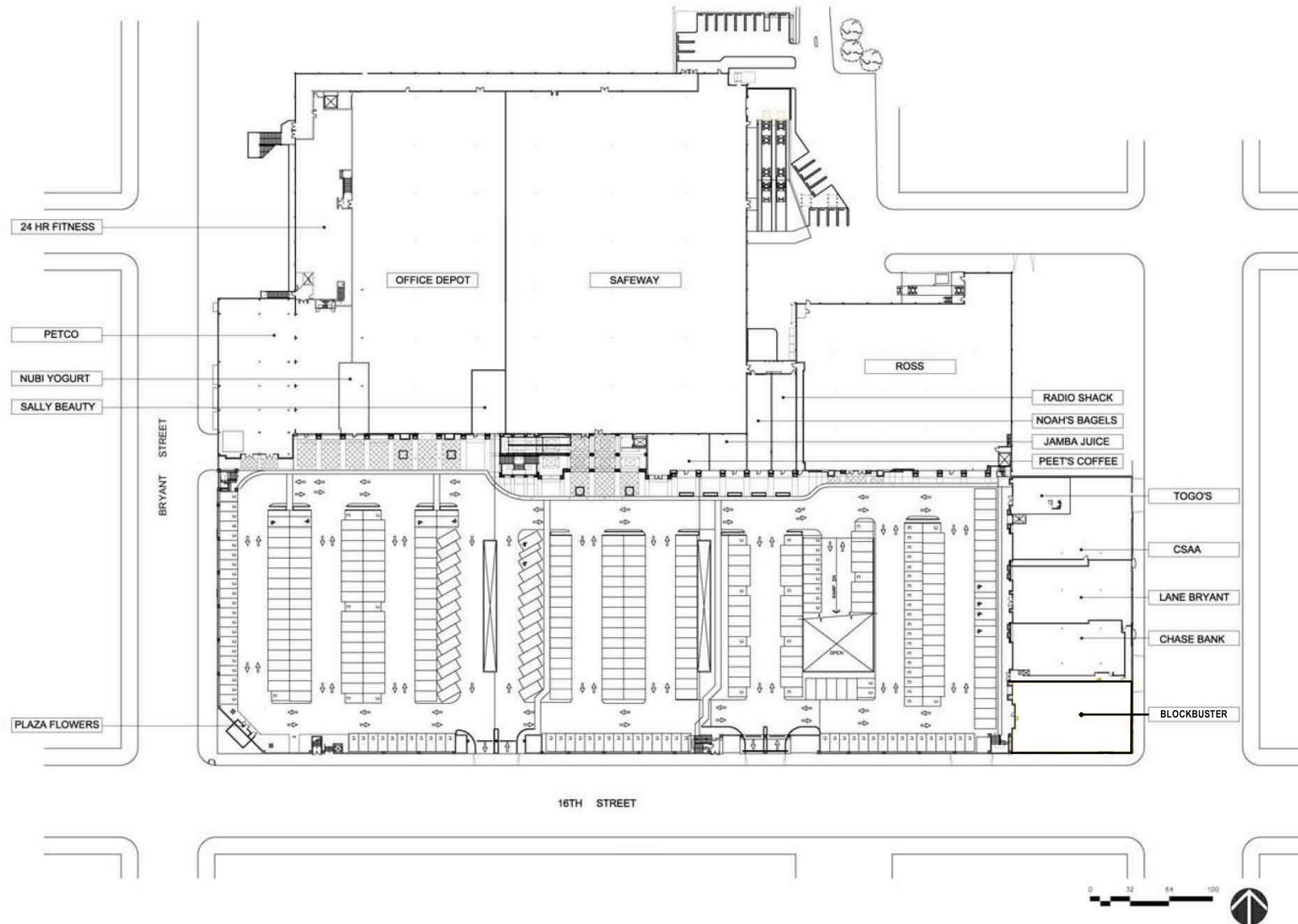

## POTRERO CENTER - UPPER LEVEL

## SITE PLAN - LOWER LEVEL

Contact: Courtney Jones (CA DRE #01232209), cjones@crosspointrealty.com Carter Hemming (CA DRE #01123464), chemming@crosspointrealty.com

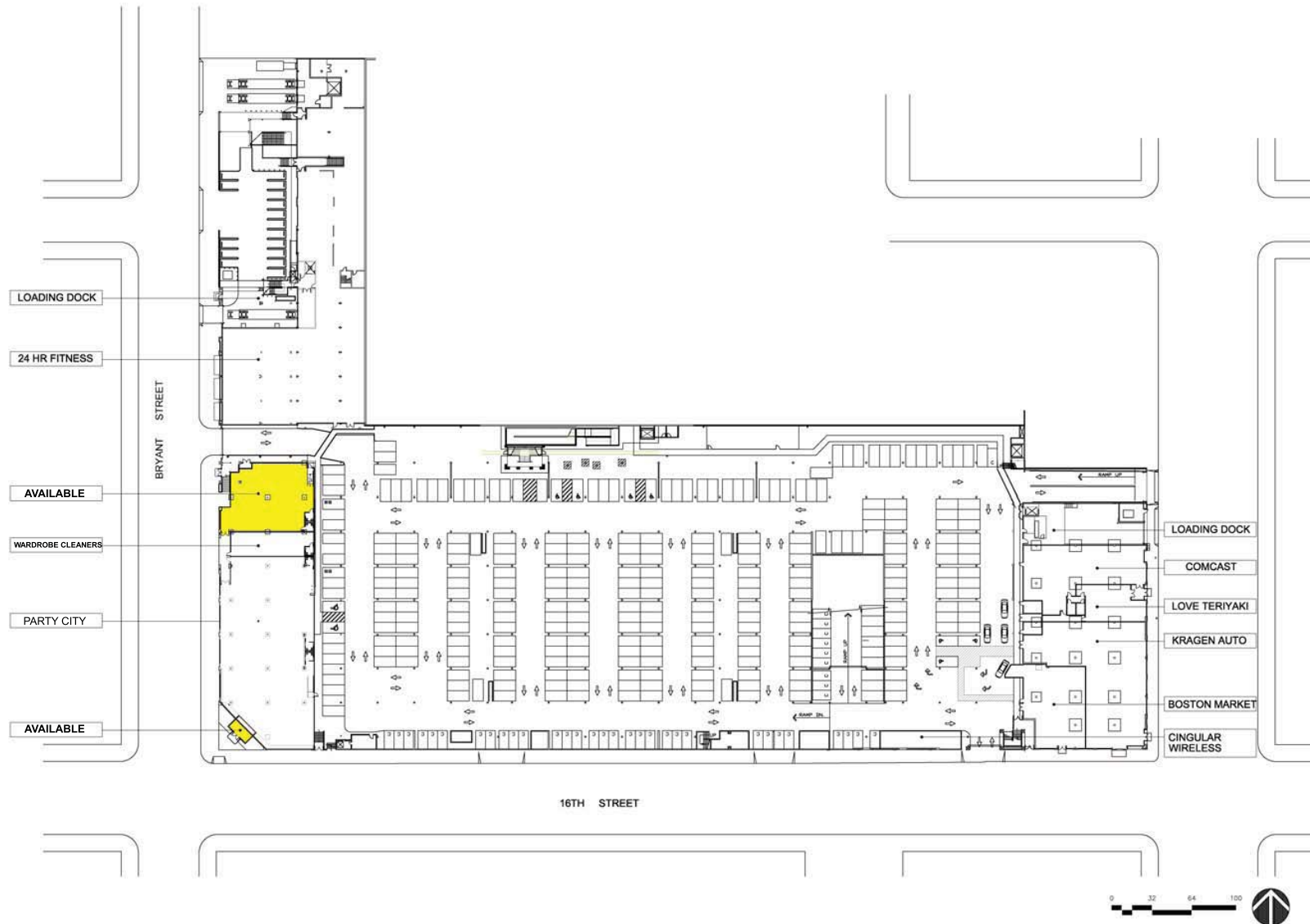

# POTRERO CENTER - LOWER LEVEL

# Potrero Center

2300 16th Street | San Francisco, California

## MARKET AREA

### Potrero Center Tenants Include:

Safeway	Nubi Yogurt
Ross	Radio Shack
Lane Bryant	Petco
Blockbuster	Office Depot
24 Hour Fitness	Kragen Auto
Peet's Coffee	Sally Beauty
Jamba Juice	Post Office
Noah's Bagels	I Love Teriyaki
Togo's	AT&T Wireless
Boston Market	CSAA Travel
Chase	1 Hr. Martinizing

### For information, contact:

**Courtney Jones**, CA DRE #01232209  
[cjones@crosspointrealty.com](mailto:cjones@crosspointrealty.com)

**Carter Hemming**, CA DRE #01123464  
[chemming@crosspointrealty.com](mailto:chemming@crosspointrealty.com)

Phone: 415.288.6888  
Fax: 415.288.6877

Crosspoint Realty Services, Inc.  
260 California Street, 4th Floor  
San Francisco, CA 94111  
[www.crosspointrealty.com](http://www.crosspointrealty.com)

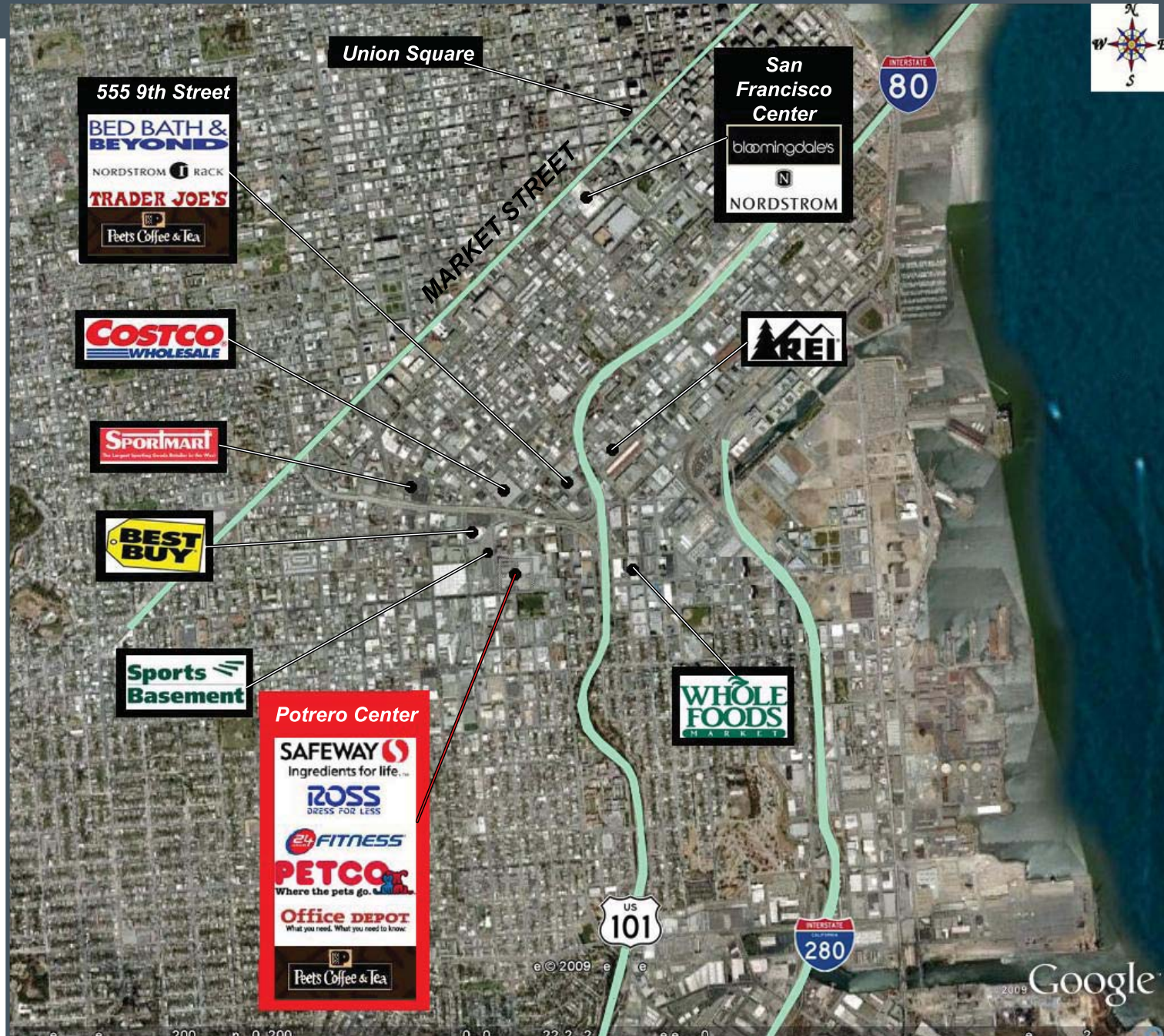

# Potrero Center

2300 16th Street | San Francisco, California

## MAP & INFORMATION

### Description:

Potrero Center is a grocery anchored community center consisting of 227,000 square feet of retail shops, services and restaurants unique to San Francisco. Potrero Center offers a combination of high visibility, excellent demographics and ample parking.

### Location:

2300 16th Street, San Francisco, CA 94103  
Potrero Center is located at 2300 16th Street in the growing Potrero Hill district of San Francisco.

### For information, contact:

**Courtney Jones**, CA DRE #01232209  
[cjones@crosspointrealty.com](mailto:cjones@crosspointrealty.com)

**Carter Hemming**, CA DRE #01123464  
[chemming@crosspointrealty.com](mailto:chemming@crosspointrealty.com)

Phone: 415.288.6888

Fax: 415.288.6877

Crosspoint Realty Services, Inc.  
260 California Street, 4th Floor  
San Francisco, CA 94111  
[www.crosspointrealty.com](http://www.crosspointrealty.com)

