



Robinhood Plaza

5756 Pacific Avenue | Stockton, California

NOW LEASING

SPACE #	SF	RENT	NNN
D-5	760	Call	\$.30
D-7	2,147	Call	\$.30
Combo D5&D7	2,907	Call	\$.30
Combo C7&9	3,972	Call	\$.30

For information, contact:

Tracey O'Neill, CA DRE #01429921
toneill@crosspointrealty.com

Carter Hemming, CA DRE #01123464
chemming@crosspointrealty.com

Phone: 415.288.6888
Fax: 415.288.6877

Crosspoint Realty Services, Inc.
260 California Street, 4th Floor
San Francisco, CA 94111
www.crosspointrealty.com

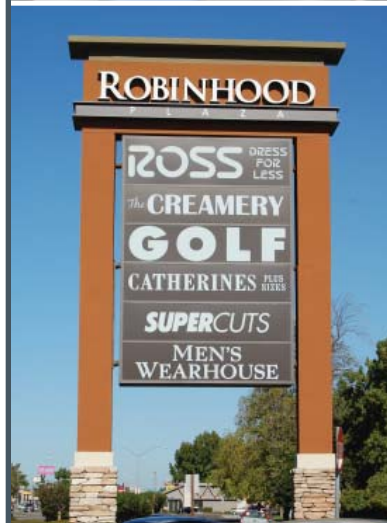

SITE PLAN

Contact: Tracey O'Neill (CA DRE #01429921), toneill@crosspointrealty.com Carter Hemming (CA DRE #01123464), chemming@crosspointrealty.com Phone: 415.288.6888

NOTES:

- 1: THIS EXHIBIT IS NOT A REPRESENTATION, COVENANT OR WARRANTY BY LANDLORD AS TO ANY SIZE, LOCATION, OR OCCUPANCY OF ANY TENANT OR OTHER OCCUPANT OF BUILDING LOCATED WITH IN THE SHOPPING CENTER.
- 2: THIS EXHIBIT IS DIAGRAMATIC AND IS FOR THE PURPOSE ONLY OF INDICATING THE LOCATION OF THE PROPOSED LEASE PREMISES. IT DOES NOT PURPORT TO SHOW THE EXACT OR FINAL LOCATION, SQUARE FOOTAGE OF DIMENSIONS OF THE LEASE PREMISES.
- 3: LANDLORD HAS FIRST PRIORITY FOR THE USE AND ACCESS OF THE SPACE ABOVE CEILING AREAS FOR THE MECHANICAL, ELECTRICAL, AND STRUCTURAL.
- 4: THE CONFIGURATION OF STORES AND OCCUPANTS CONTAINED IN THE LEASING PLAN AND PARKING ARE SUBJECT TO CHANGE FROM TIME TO TIME WITH OUT NOTICE.



PHONE: (209) 478-1791
FAX: (209) 952-1654
WWW.STONEBROSMANAGEMENT.COM



LEASING COMPANY: CROSSPOINT REALTY
CONTACT: TRACEY O'NEILL
PHONE: (415) 288-6888
WWW.CROSSPOINTREALTY.COM

SPECIALTY LEASING:
PHONE: (209) 478-1791

"ROBINHOOD PLAZA" NOTES:
THE DESCRIPTION OF THE PROJECT AND/OR BUILDINGS SHOWN HEREIN IS FOR INFORMATIONAL PURPOSES ONLY. LDA PARTNERS ARCHITECTS, LLP DOES NOT WARRANT OR REPRESENT THAT THE PROJECT AND/OR BUILDING(S) WILL BE EXACTLY AS INDICATED HEREIN, OR THAT ANY OF THE BUSINESSES OR TENANTS SHOWN HEREIN WILL BECOME AND/OR REMAIN AS OCCUPANTS OF THE PROJECT.

LDA PARTNERS ARCHITECTS, LLP NOTES: THE INFORMATION SHOWN ON THIS DOCUMENT MAY BE BASED ON INCOMPLETE PROGRESS DRAWINGS PREPARED FOR "ROBINHOOD PLAZA" AND IS LIMITED TO ARCHITECTURAL INFORMATION PLUS STRUCTURAL COLUMNS, BRACING AND BEAMS. JOINTS, ALL INFORMATION IS SUBJECT TO CHANGE.

TENANT LEASE AREAS ARE MEASURED FROM THE LEASE LINE AT THE STOREFRONT TO EXTERIOR FACE OF EXTERIOR WALLS AND/OR SERVICE CORRIDORS AND CENTER LINE OF ADJACENT TENANT DEMISING WALLS. THE INDICATED AREAS (SQUARE FEET) ARE FOR INFORMATIONAL PURPOSES ONLY AND ARE NOT A WARRANTY, REPRESENTATION, OR AGREEMENT THAT THE DELINEATED SPACE WILL BE CONSTRUCTED EXACTLY AS DIMENSIONED OR INDICATED HEREIN.

THIS DOCUMENT IS APPROPRIATE FOR USE IN PRE-LEASING BY "STONE BROS. INC." IT IS THE RESPONSIBILITY OF TENANTS TO CONFIRM FINAL TENANT LAYOUT AND ALL ELEMENTS AFFECTING THEIR PREMISES WITH "CROSSPOINT LEASING, INC."

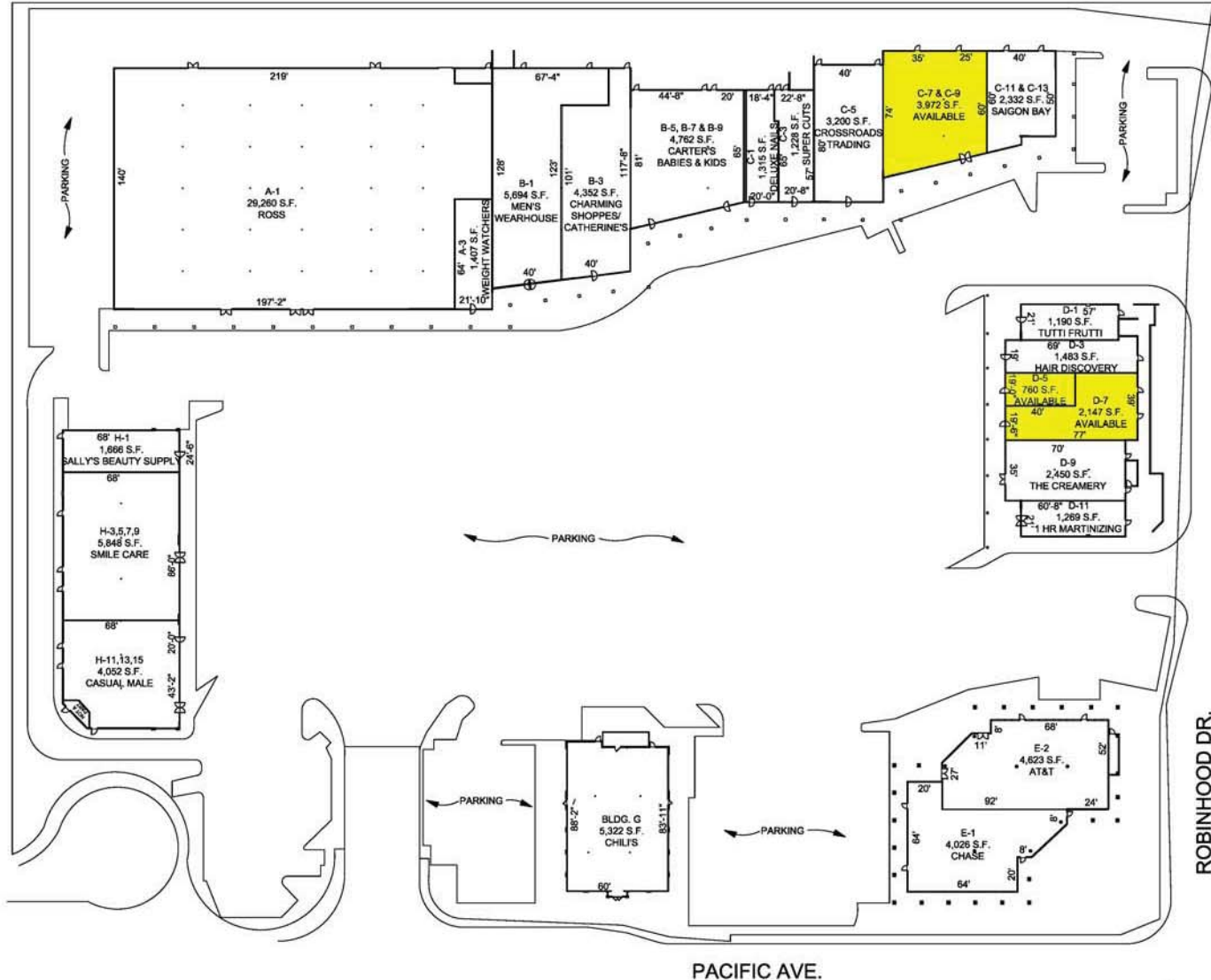

MASTER LEASE PLAN - ROBINHOOD PLAZA

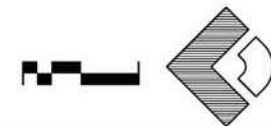

SCALE: 1"= 30'-0"

Robinhood Plaza

5756 Pacific Avenue | Stockton, California

MARKET AREA

Robinhood Plaza Tenants Include:

- | | |
|-----------------|-----------------|
| Ross | Smile Care |
| Chili's | Deluxe Nails |
| Men's Wearhouse | Saigon Bay |
| Catherines | Tutti Frutti |
| Casual Male | The Creamery |
| Carters | Hair Discovery |
| AT&T Wireless | One Hour |
| Chase | Martinizing |
| Sally Beauty | Weight Watchers |
| Supercuts | |
| Crossroad's | |
| Trading | |

For information, contact:

Tracey O'Neill, CA DRE #01429921
toneill@crosspointrealty.com

Carter Hemming, CA DRE #01123464
chemming@crosspointrealty.com

Phone: 415.288.6888
Fax: 415.288.6877

Crosspoint Realty Services, Inc.
260 California Street, 4th Floor
San Francisco, CA 94111
www.crosspointrealty.com



Robinhood Plaza

5756 Pacific Avenue | Stockton, California

MAP & INFORMATION

Description:

A 93,000 SF Community Center at the hub of Stockton's retail district. Surrounded by high-density residential and numerous office buildings. Adjacent to Sherwood Mall, Stonecreek Village and San Joaquin Delta College.

Location:

5756 Pacific Avenue, northeast corner of Pacific Avenue and Robinhood Drive.

For information, contact:

Tracey O'Neill, CA DRE #01429921

toneill@crosspointrealty.com

Carter Hemming, CA DRE #01123464

chemming@crosspointrealty.com

Phone: 415.288.6888

Fax: 415.288.6877

Crosspoint Realty Services, Inc.

260 California Street, 4th Floor

San Francisco, CA 94111

www.crosspointrealty.com

