



Sherwood Mall

5308 Pacific Avenue | Stockton, California

NOW LEASING

SPACE #	SF	RENT	NNN
Bldg F, Suite C	1,715	Call	\$3.60
Anchor Opportunity	90,823	Call	\$3.60
Interior Opportunities		Call	\$14.22
Food Court Opportunities		Call	\$32.86

For information, contact:

Carter Hemming, CA DRE #01123464
chemming@crosspointrealty.com

Phone: 415.288.6888
Fax: 415.288.6877

Crosspoint Realty Services, Inc.
260 California Street, 4th Floor
San Francisco, CA 94111
www.crosspointrealty.com



SITE PLAN

Contact: Carter Hemming (CA DRE #01123464), chemming@crosspointrealty.com Phone: 415.288.6888

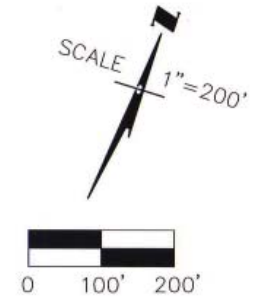

LEASING PLAN

Contact: Carter Hemming (CA DRE #01123464), chemming@crosspointrealty.com Phone: 415.288.6888

THE PATIO RESTAURANTS KEY

- 88 TODA SUSHI
- 90 HOT DOG ON A STICK
- 92 SUBWAY/TACOY
- 96 MCDONALD'S
- 98 CHINESE GOURMET EXPRESS
- 100 PIZZAGO
- 104 SALSICA PISCANTE
- 106 SORABOL KOREAN BBQ
- 108 ORANGE JULIUS

KIOSK KEY

- 36 TREASURE ISLAND
- 37 PRECISION TIME
- 38 CELL SOUNDS
- 122 JEWELRY COLLECTIONS

MACARONI GRILL 6,900 S.F.	ELEPHANT BAR RESTAURANT 8,767 S.F.
------------------------------	---------------------------------------

BUILDING "J" PAD	
J-1 PANDA EXPRESS	2,350 S.F.
J-2 JIM BOY'S TACOS	2,600 S.F.
J-3 LILI'S DELI	849 S.F.
J-4 STARBUCKS	1,400 S.F.

BUILDING "F" PAD	
AVAILABLE	1,715 S.F.
FRESHER NAILS AND SPA	4,922 S.F.

WELLS FARGO	4,000 S.F.
-------------	------------

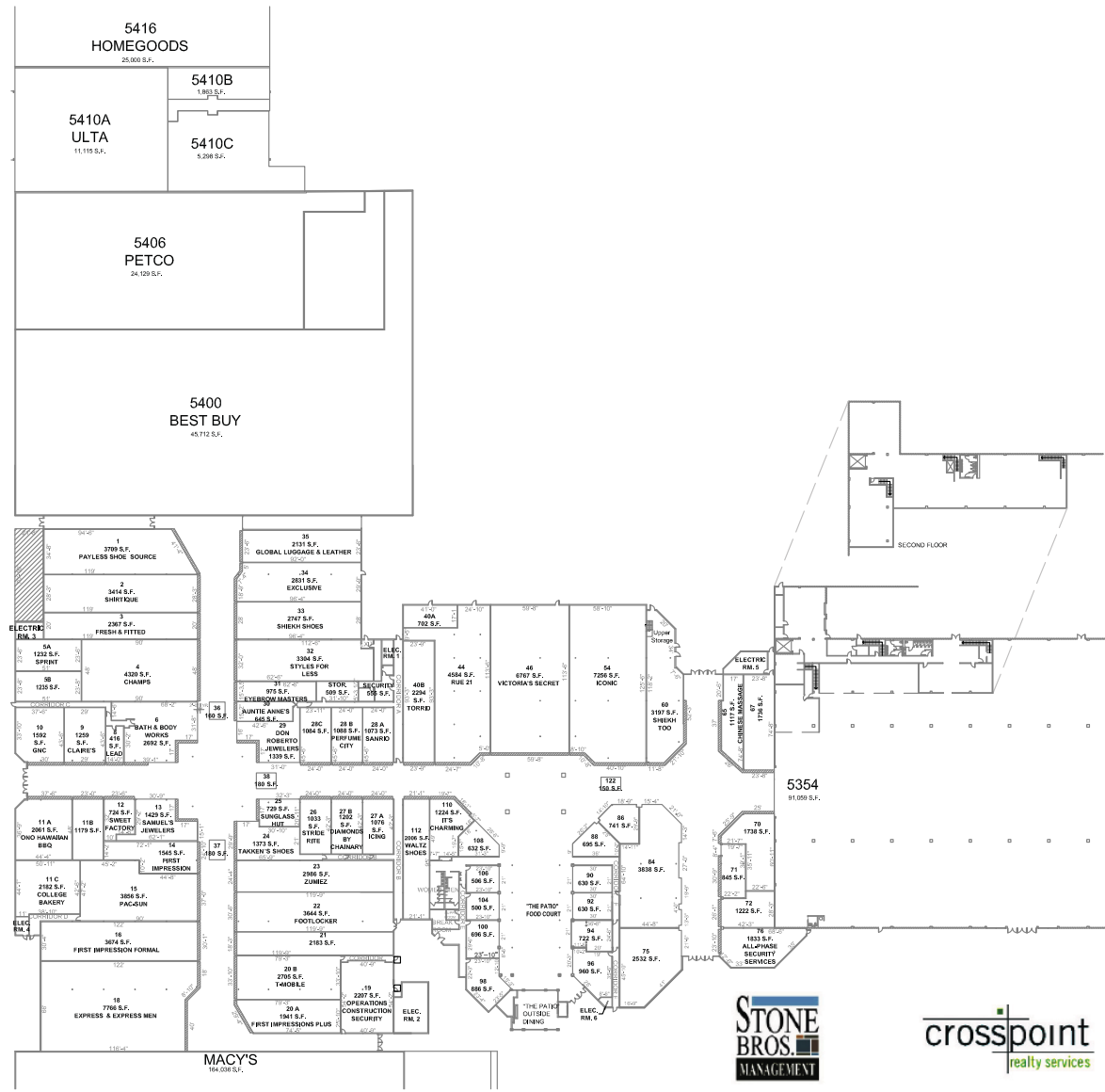

PHONE: (209) 478-1791
www.stonebrosmgmt.com
www.shopstonecreekvillepage.com



LEASING COMPANY: CROSSPOINT REALTY
CONTACT: CARTER HEMMING
PHONE: (415) 288-6888
www.crosspointrealty.com

SPECIALTY LEASING:
PHONE: (209) 478-1791



SCALE	NTS
DATE	03.08.12

SHERWOOD MALL
5308 PACIFIC AVENUE
STOCKTON, CA 95207

Sherwood Mall

5308 Pacific Avenue | Stockton, California

MARKET AREA

Sherwood Mall Tenants Include:

- | | |
|----------------------|-------------------|
| Macy's | Peck's Jewelers |
| Best Buy | Footlocker |
| Home Goods | Zumiez |
| Petco | Auntie Anne's |
| Ulta | Takken's Shoes |
| Macaroni Grill | Sunglass Hut |
| Elephant Bar | Game Stop |
| Payless Shoes | San Rio |
| Shirtique | Stride Rite |
| Sheikh Shoes | Icing |
| Champs | Waltz Shoes |
| Sprint | Torrid |
| GNC | Victoria's Secret |
| Claire's | Bloom |
| Bath & Body Works | Shiekh Too |
| Don Roberto Jewelers | Baja Fresh |
| Sweet Factory | Panda Express |
| Samuel's Jewelers | Ono Hawaiian BBQ |
| Pac-Sun | Starbucks |
| Express | Food Court |
| T-Mobile | |

For information, contact:

Carter Hemming, CA DRE #01123464
chemming@crosspointrealty.com

Phone: 415.288.6888
Fax: 415.288.6877

Crosspoint Realty Services, Inc.
260 California Street, 4th Floor
San Francisco, CA 94111
www.crosspointrealty.com



Sherwood Mall

5308 Pacific Avenue | Stockton, California

MAP & INFORMATION

Description:

The region's favorite Mall, located at the strongest retail intersection in the region. Surrounded by high-density residential communities and numerous office developments. Adjacent to Stonecreek Village, Robinhood Plaza and San Joaquin Delta College.

Location:

5308 Pacific Avenue, southeast corner of Pacific Avenue and Robinhood Drive.

For information, contact:

Carter Hemming, CA DRE #01123464
chemming@crosspointrealty.com

Phone: 415.288.6888
Fax: 415.288.6877

Crosspoint Realty Services, Inc.
260 California Street, 4th Floor
San Francisco, CA 94111
www.crosspointrealty.com

