



Marina Square

1201 – 1299 Marina Blvd | San Leandro, California

NOW LEASING

SPACE#	SF	RENT	NNN
No Availability			



For information, contact:

Thomas N. Klein, CA BRE #00840486
tklein@crosspointrealty.com

Phone: 415-288-6888
Fax: 415-288-6877

Crosspoint Realty Services, Inc.
303 Sacramento Street, 3rd Floor
San Francisco, CA 94111
www.crosspointrealty.com

SITE PLAN

Contact: Thomas N. Klein (CA BRE#00840486), tklein@crosspointrealty.com Phone 415.288.6888

LEASING SUMMARY

1201	- FEDEX OFFICE	3,740 sf
1207	- LA SALSA HOLDING CO.	1,349 sf
1209	- STARBUCKS COFFEE	1,170 sf
1221	- ANN TAYLOR FACTORY STORE	9,295 sf
1235A	- LOFT OUTLET STORE	5,762 sf
1235B	- TALBOT'S OUTLET	4,000 sf
1237	- EILEEN FISHER COMPANY STORE	3,990 sf
1239	- MEN'S WEARHOUSE	7,820 sf
1245	- MARSHALLS	27,500 sf
1247	- CONVERSE OUTLET	3,000 sf
1251,3	- SKECHERS	5,000 sf
1257	- GUESS FACTORY STORE	5,000 sf
1259	- GAP FACTORY STORE	10,000 sf
1263	- SPRINT	2,509 sf
1267	- BATH & BODY WORKS	1,900 sf
1269	- PIEOLOGY	2,172 sf
1271	- PANDA EXPRESS	2,460 sf
1273	- GYMBOREE	2,718 sf
1275	- NIKE CLEARANCE STORE	16,219 sf
1285	- NORDSTROM RACK	42,000 sf
1291	- BANANA REPUBLIC	6,610 sf
1299	- PAC SUN OUTLET	3,040 sf
KIOSK	- BANK OF AMERICA	ATM

TOTAL 167,254 SQ.FT.

TOTAL PARKING SPACES = 926

PARKING RATIO = 5.54 PARKING SPACES/1,000 SF

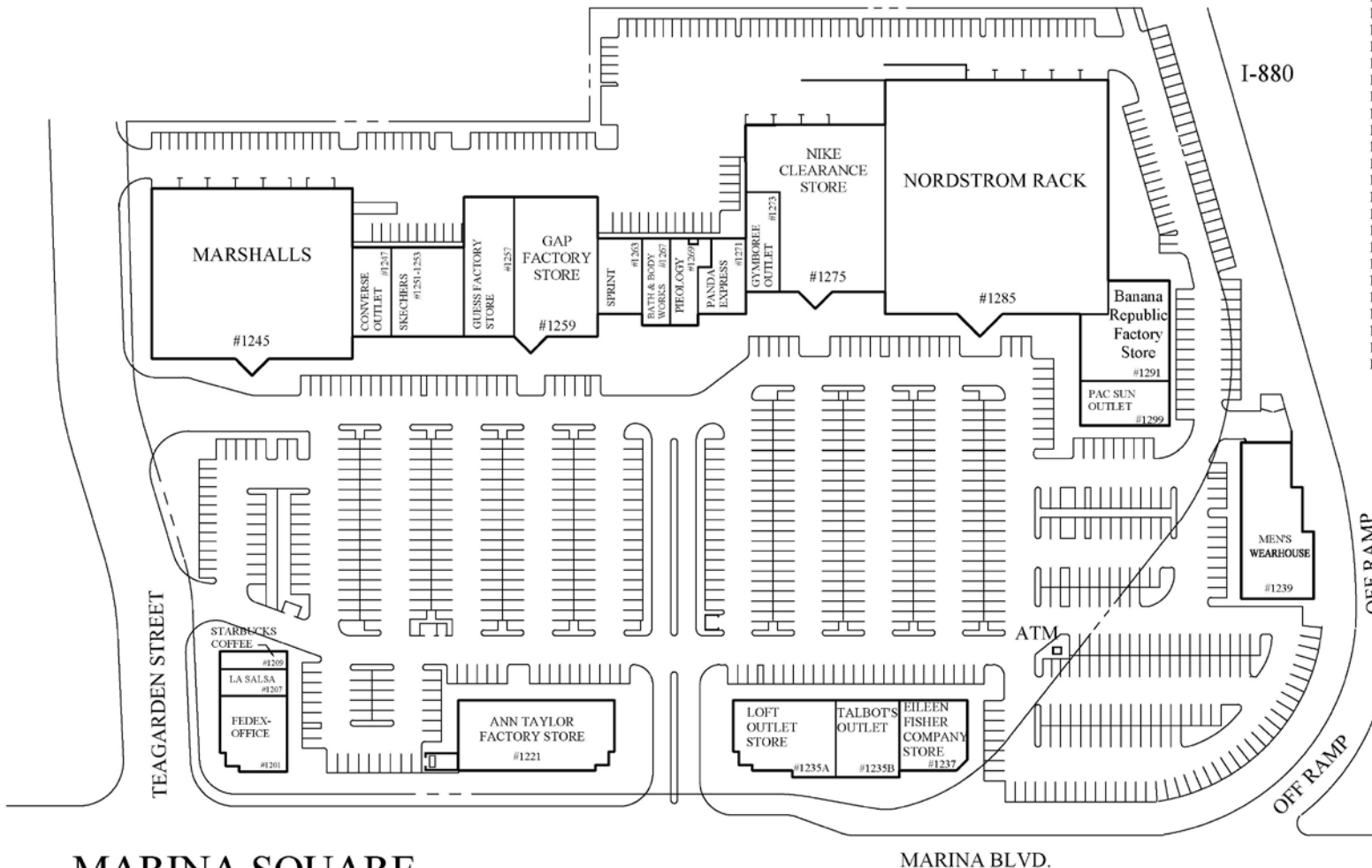

MARINA SQUARE

SHOPPING CENTER 10/6/15
San Leandro, California



This site plan is intended only to show the general layout of the property or a part thereof. Landlord reserves the right to alter, vary, add to or omit in whole or in part any structures, and/or improvements, and/or common areas and/or land area shown on this plan. All measurements and distances are approximate. This plan is not to be scaled.

MARKET AREA

Marina Square Tenants Include:

Nordstrom Rack	Nike Clearance Store
Ann Taylor Factory Store	Skechers
Talbots Outlet	Guess Outlet
LOFT Outlet	Sprint PCS
Marshalls	Bath & Body Works
GAP Outlet	Converse
Eileen Fisher Outlet	Pac Sun
Gymboree Outlet	Banana Republic Factory Store
Men's Wearhouse	FedEx Kinkos
La Salsa	Pieology
Starbucks	Panda Express

For information, contact:

Thomas N. Klein, CA BRE #00840486
tklein@crosspointrealty.com

Phone: 415-288-6888
Fax: 415-288-6877

Crosspoint Realty Services, Inc.
303 Sacramento Street, 3rd Floor
San Francisco, CA 94111
www.crosspointrealty.com

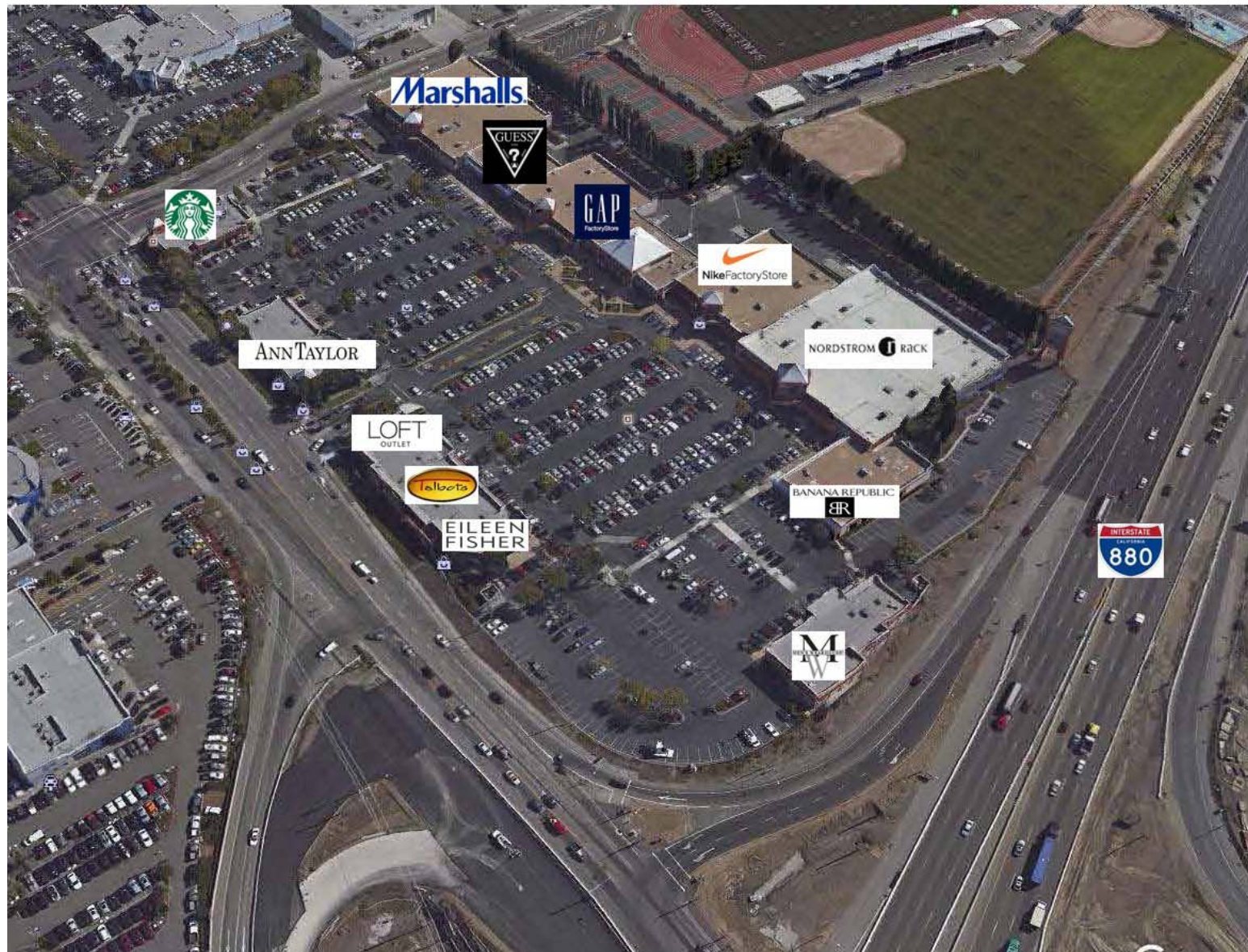

Marina Square

1201 -1299 Marina Blvd | San Leandro, California

MAP & INFORMATION

Description:

The only outlet center located in the bulls-eye of the San Francisco Bay Area featuring top-tier apparel and accessories tenants. Very high sales per square foot. Exceptional foot traffic and freeway exposure.

Location:

1201 – 1299 Marina Blvd., San Leandro, CA
Off I880 at Marin Boulevard, adjacent to the freeway.

For information, contact:

Thomas N. Klein, CA BRE #00840486
tklein@crosspointrealty.com

Phone: 415-288-6888
Fax: 415-288-6877

Crosspoint Realty Services, Inc.
303 Sacramento Street, 3rd Floor
San Francisco, CA 94111
www.crosspointrealty.com

