



On Broadway

Jefferson Ave & Broadway | Redwood City, California

NOW LEASING

<u>SPACE#</u>	<u>SF</u>	<u>RENT</u>	<u>NNN</u>
P-2 (Office Space)	3,689	\$60 psf Per year	Gross

For information, contact:

Courtney Jones, CA BRE #01232209
cjones@crosspointrealty.com

Thomas N. Klein, CA BRE #00840486
tklein@crosspointrealty.com

Phone: 415-288-6888
Fax: 415-288-6877

Crosspoint Realty Services, Inc.
303 Sacramento Street, 3rd Floor
San Francisco, CA 94111
www.crosspointrealty.com



SITE PLAN

Contact: Courtney Jones (CA BRE#01232209), cjones@crosspointrealty.com; Thomas N. Klein (CA BRE#00840486), tklein@crosspointrealty.com Phone 415.288.6888

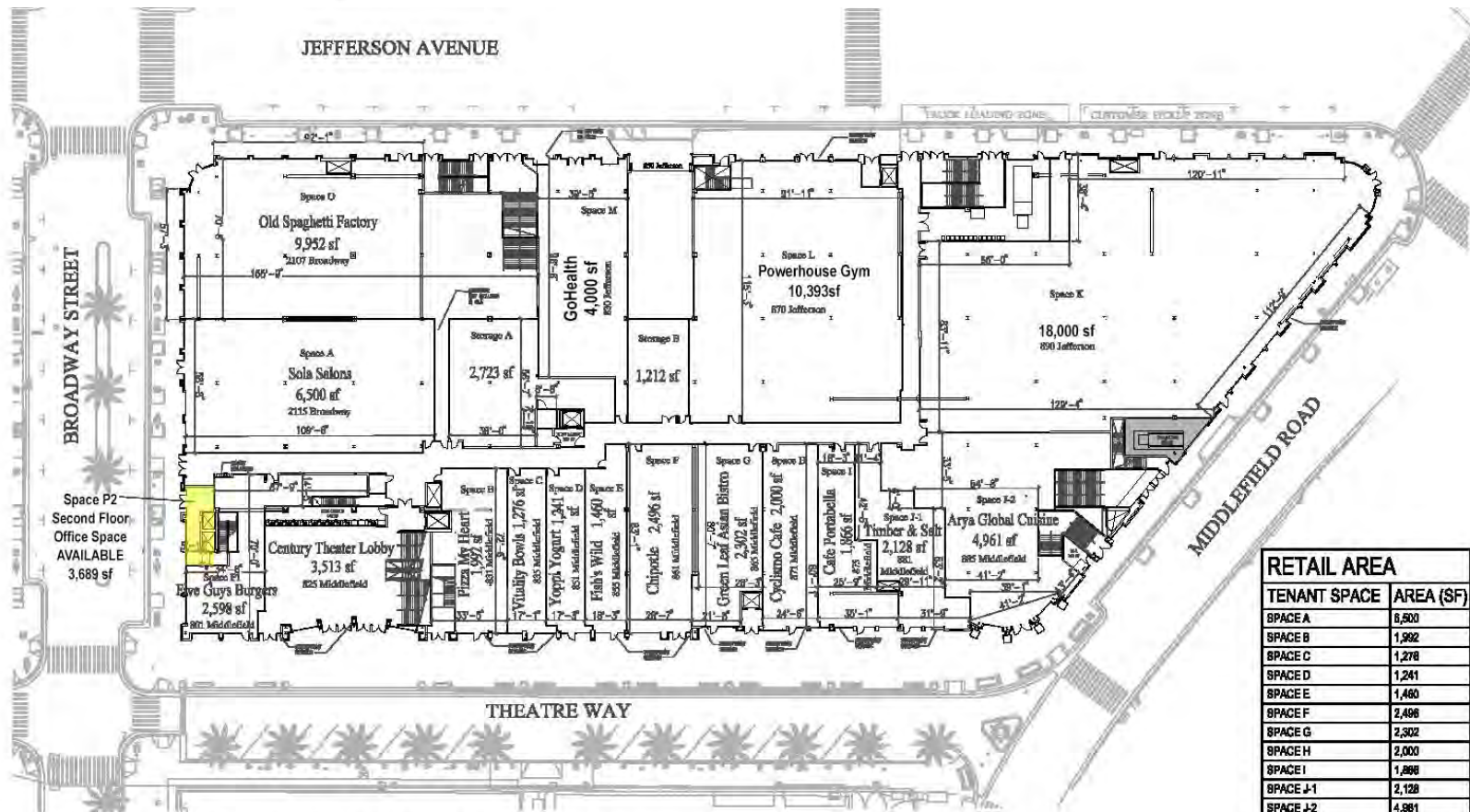

RETAIL AREA

TENANT SPACE	AREA (SF)
SPACE A	6,500
SPACE B	1,992
SPACE C	1,278
SPACE D	1,241
SPACE E	1,480
SPACE F	2,496
SPACE G	2,302
SPACE H	2,000
SPACE I	1,898
SPACE J-1	2,128
SPACE J-2	4,961
SPACE K	18,000
SPACE L	10,393
SPACE M	4,000
SPACE O	9,952
SPACE P1	2,598
SPACE P2 (UPSTAIRS)	3,689
SUBTOTAL	76,854

CENTURY THEATRE

TENANT SPACE	AREA (SF)
THEATRES & CONCESS.	67,476
BOX OFFICE	442
SUBTOTAL	67,918
TOTAL GLA	144,772

ON BROADWAY FIRST FLOOR LEASE PLAN

REDWOOD CITY, CA APRIL 7, 2015

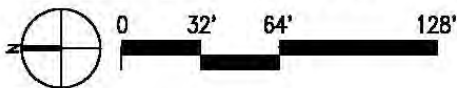

Deutsche Asset & Wealth Management

FOR LEASING INFORMATION:
Tom Klein & Courtney Jones
Crosspoint Realty Services, Inc.
280 California Street
San Francisco, CA 94111
www.crosspointrealty.com
P: 415.288.6888 F: 415.288.8877

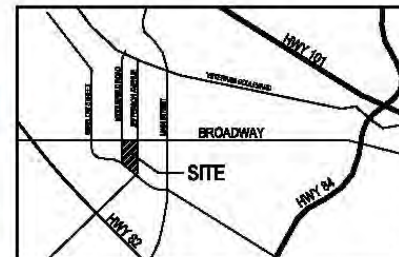

LOCATION MAP

DISCLAIMER:
THIS SITE PLAN IS INTENDED ONLY TO SHOW THE GENERAL LAYOUT OF THE PROPERTY OR A PART THEREOF. LANDLORD RESERVES THE RIGHT TO ALTER, VARY, ADD OR OMIT IN WHOLE OR IN PART ANY STRUCTURES, AND/OR IMPROVEMENTS, TENANT NAMES, STORE SIZES AND/OR LAND AREA SHOWN ON THIS PLAN. ALL MEASUREMENTS AND DISTANCES ARE APPROXIMATE. THIS PLAN IS NOT TO BE SCALED.

SPACE PLAN

Contact: Courtney Jones (CA BRE#01232209), cjones@crosspointrealty.com; Thomas N. Klein (CA BRE#00840486), tklein@crosspointrealty.com Phone 415.288.6888

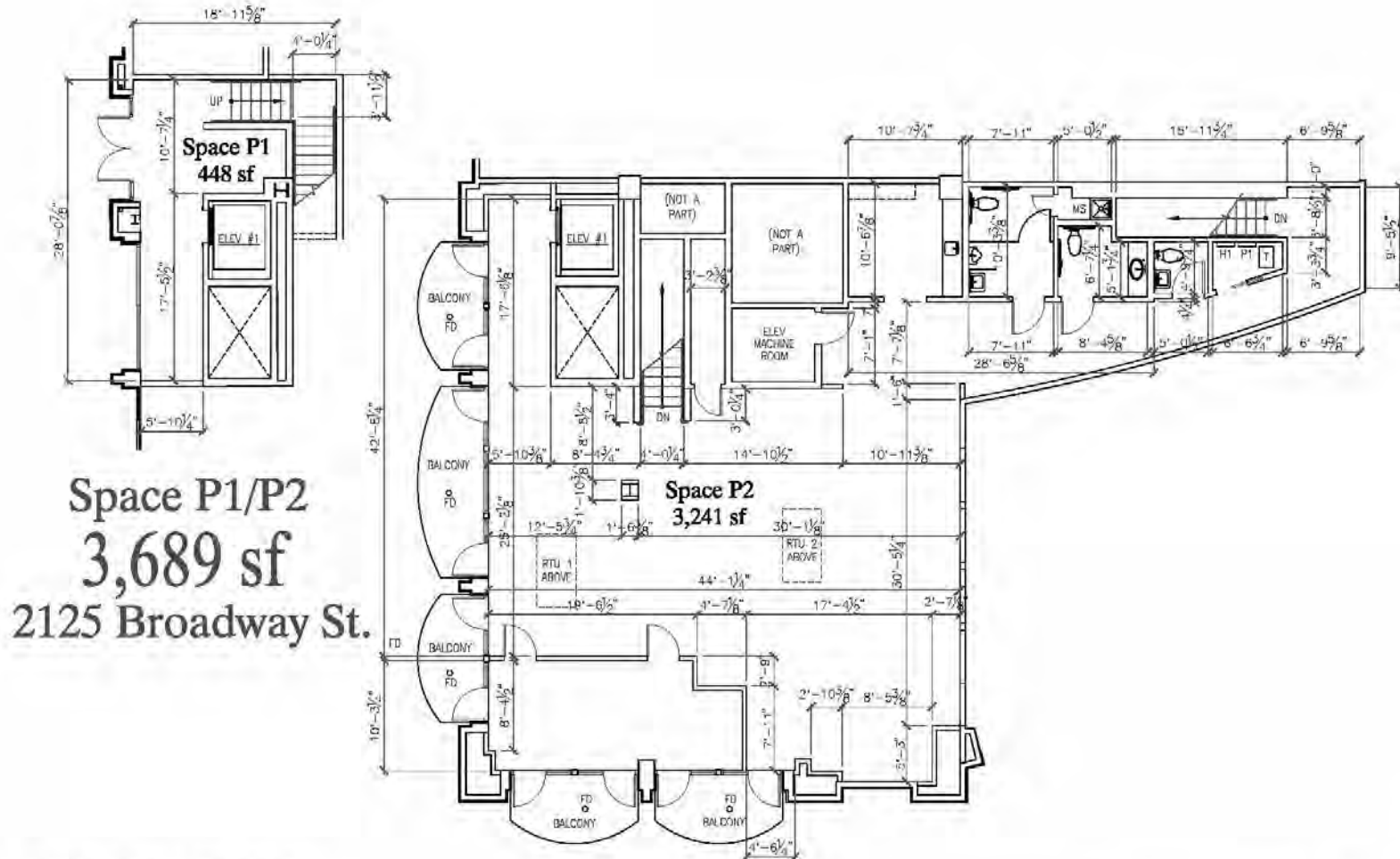

Space P1/P2
3,689 sf
2125 Broadway St.

ON BROADWAY SPACES P1/P2 - LEASE PLAN
REDWOOD CITY, CA January 22, 2018

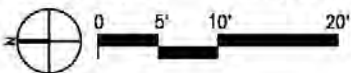

Deutsche Asset
& Wealth Management

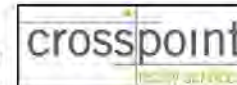

FOR LEASING INFORMATION:
Tom Klein & Courtney Jones
Crosspoint Realty Services, Inc.
280 California Street
San Francisco, CA 94111
www.crosspointrealty.com
P: 415.288.6888 F: 415.288.6877

DISCLAIMER:
THIS SITE PLAN IS INTENDED ONLY TO SHOW THE GENERAL LAYOUT OF THE PROPERTY OR A PART THEREOF. LANDLORD RESERVES THE RIGHT TO ALTER, VARY, ADD OR OMIT IN WHOLE OR IN PART ANY STRUCTURES, AND/OR IMPROVEMENTS, TENANT NAMES, STORE SIZES AND/OR LAND AREA SHOWN ON THIS PLAN. ALL MEASUREMENTS AND DISTANCES ARE APPROXIMATE. THIS PLAN IS NOT TO BE SCALED.

On Broadway

Jefferson Ave & Broadway | Redwood City, California

MARKET AREA

On Broadway Tenants Include:

- | | |
|---------------------|-------------------------|
| Century Theaters 20 | Old Spaghetti Factory |
| Powerhouse Gym | Five Guys Burgers |
| Vitality Bowl | Cyclismo Cafe |
| Yoho Yogurt | Sola Salons |
| Café Portabella | Green Leaf Asian Bistro |
| Chipotle | Timber & Salt |
| Fish's Wild | Go Health Urgent Care |
| Pizza My Heart | |

For information, contact:

Courtney Jones, CA BRE #01232209
cjones@crosspointrealty.com

Thomas N. Klein, CA BRE #00840486
tklein@crosspointrealty.com

Phone: 415-288-6888
Fax: 415-288-6877

Crosspoint Realty Services, Inc.
303 Sacramento Street, 3rd Floor
San Francisco, CA 94111
www.crosspointrealty.com

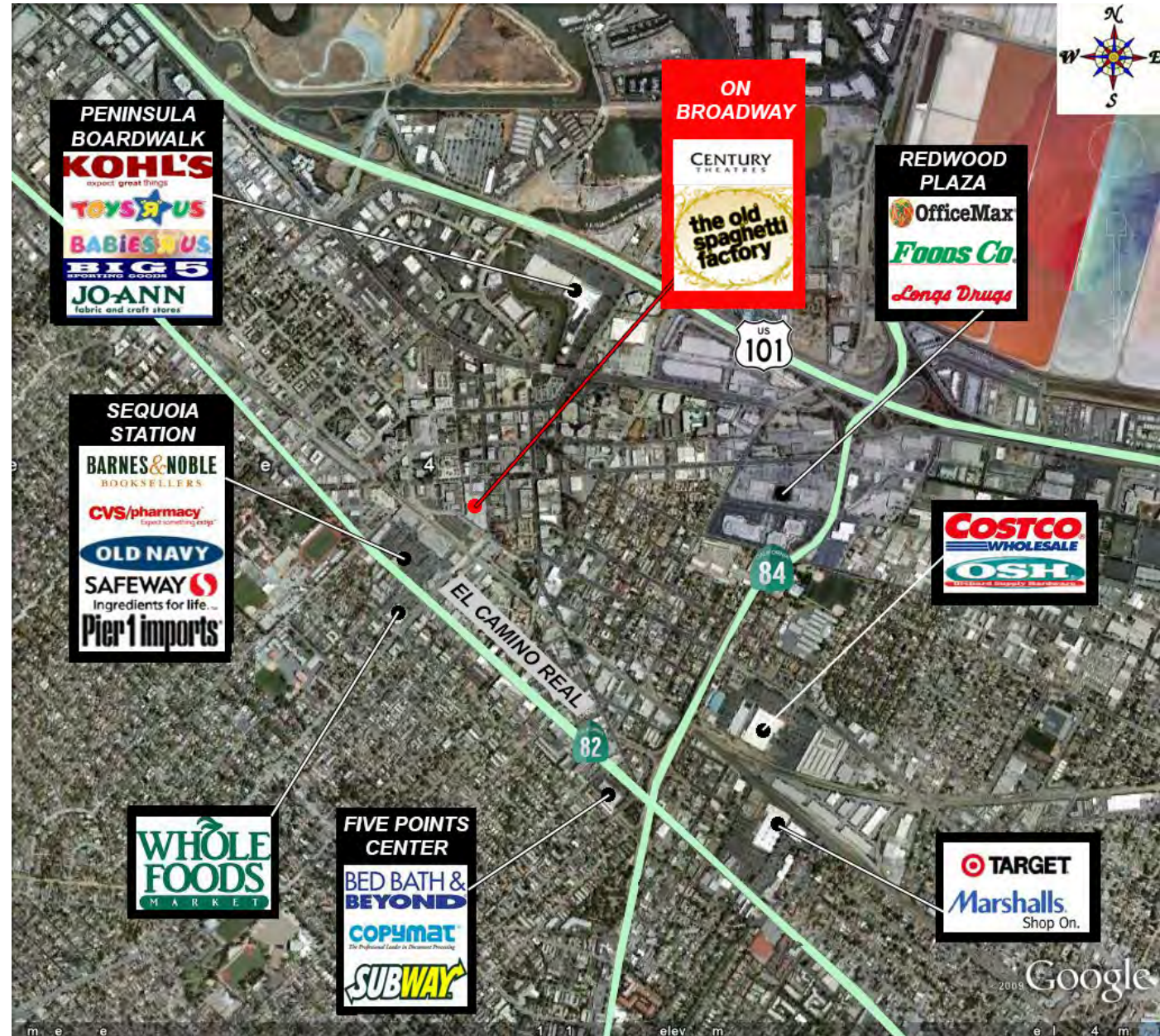

On Broadway

Jefferson Ave & Broadway | Redwood City , California

MAP & INFORMATION

Description:

On Broadway is a 145,000 square foot entertainment retail center built in 2006 and anchored by a state of the art, 20 screen Century Theater complex. Jefferson Avenue is the main artery into downtown Redwood City from El Camino Real and Cost Plus anchors the Jefferson Avenue / Middlefield Road corner. Theater Way borders the north side of the project and includes various restaurants. The project also includes 585 easily accessible subterranean parking spaces.

Location:

Jefferson Avenue & Broadway Street, Redwood City, CA

For information, contact:

Courtney Jones, CA BRE #01232209
cjones@crosspointrealty.com

Thomas N. Klein, CA BRE #00840486
tklein@crosspointrealty.com

Phone: 415-288-6888
Fax: 415-288-6877

Crosspoint Realty Services, Inc.
303 Sacramento Street, 3rd Floor
San Francisco, CA 94111
www.crosspointrealty.com

