



# On Broadway

Jefferson Ave & Broadway | Redwood City, California

## NOW LEASING

<u>SPACE#</u>	<u>SF</u>	<u>RENT</u>	<u>NNN</u>
P-2 (Office Space)	3,689	\$60 psf Per year	Gross

### For information, contact:

**Courtney Jones**, CA BRE #01232209  
[cjones@crosspointrealty.com](mailto:cjones@crosspointrealty.com)

**Thomas N. Klein**, CA BRE #00840486  
[tklein@crosspointrealty.com](mailto:tklein@crosspointrealty.com)

Phone: 415-288-6888  
Fax: 415-288-6877

Crosspoint Realty Services, Inc.  
303 Sacramento Street, 3<sup>rd</sup> Floor  
San Francisco, CA 94111  
[www.crosspointrealty.com](http://www.crosspointrealty.com)



### SITE PLAN

Contact: Courtney Jones (CA BRE#01232209), [cjones@crosspointrealty.com](mailto:cjones@crosspointrealty.com); Thomas N. Klein (CA BRE#00840486), [tklein@crosspointrealty.com](mailto:tklein@crosspointrealty.com) Phone 415.288.6888

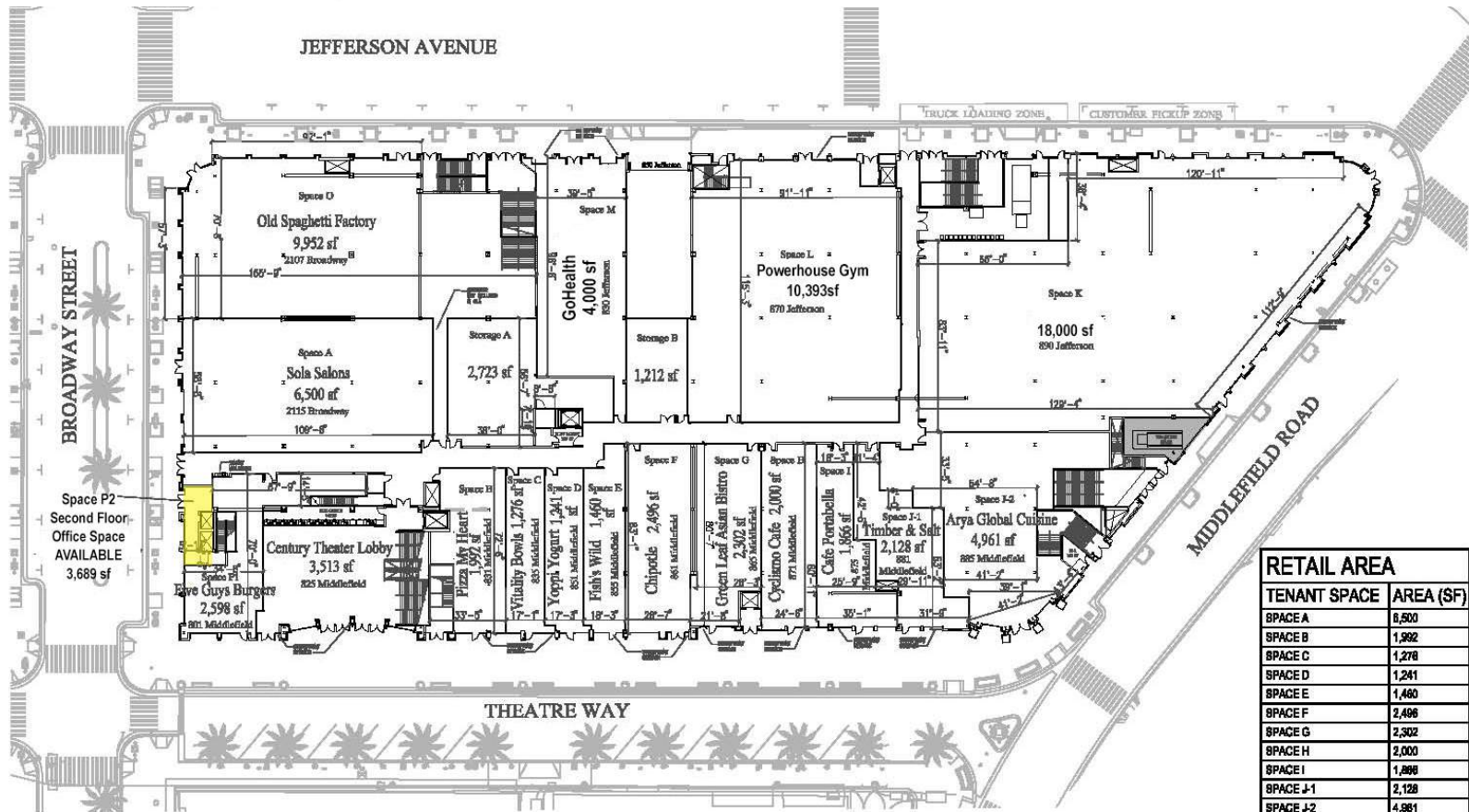

RETAIL AREA	
TENANT SPACE	AREA (SF)
SPACE A	6,500
SPACE B	1,992
SPACE C	1,278
SPACE D	1,241
SPACE E	1,480
SPACE F	2,496
SPACE G	2,302
SPACE H	2,000
SPACE I	1,898
SPACE J-1	2,128
SPACE J-2	4,961
SPACE K	18,000
SPACE L	10,393
SPACE M	4,000
SPACE O	9,952
SPACE P1	2,598
SPACE P2 (UPSTAIRS)	3,689
<b>SUBTOTAL</b>	<b>76,854</b>
CENTURY THEATRE	
TENANT SPACE	AREA (SF)
THEATRES & CONCESS.	67,476
BOX OFFICE	442
<b>SUBTOTAL</b>	<b>67,918</b>
<b>TOTAL GLA</b>	<b>144,772</b>

### ON BROADWAY FIRST FLOOR LEASE PLAN

REDWOOD CITY, CA APRIL 7, 2015

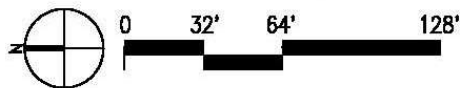

Deutsche Asset & Wealth Management

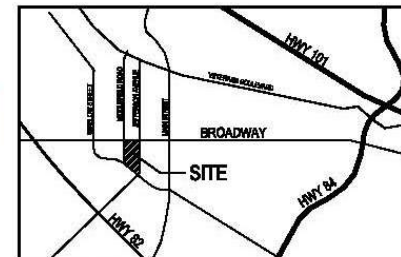

LOCATION MAP

**DISCLAIMER:**  
THIS SITE PLAN IS INTENDED ONLY TO SHOW THE GENERAL LAYOUT OF THE PROPERTY OR A PART THEREOF. LANDLORD RESERVES THE RIGHT TO ALTER, VARY, ADD OR OMIT IN WHOLE OR IN PART ANY STRUCTURES, AND/OR IMPROVEMENTS, TENANT NAMES, STORE SIZES AND/OR LAND AREA SHOWN ON THIS PLAN. ALL MEASUREMENTS AND DISTANCES ARE APPROXIMATE. THIS PLAN IS NOT TO BE SCALED.

**FOR LEASING INFORMATION:**  
Tom Klein & Courtney Jones  
Crosspoint Realty Services, Inc.  
280 California Street  
San Francisco, CA 94111  
[www.crosspointrealty.com](http://www.crosspointrealty.com)  
P: 415.288.6888 F: 415.288.6877

### SPACE PLAN

Contact: Courtney Jones (CA BRE#01232209), [cjones@crosspointrealty.com](mailto:cjones@crosspointrealty.com); Thomas N. Klein (CA BRE#00840486), [tklein@crosspointrealty.com](mailto:tklein@crosspointrealty.com) Phone 415.288.6888

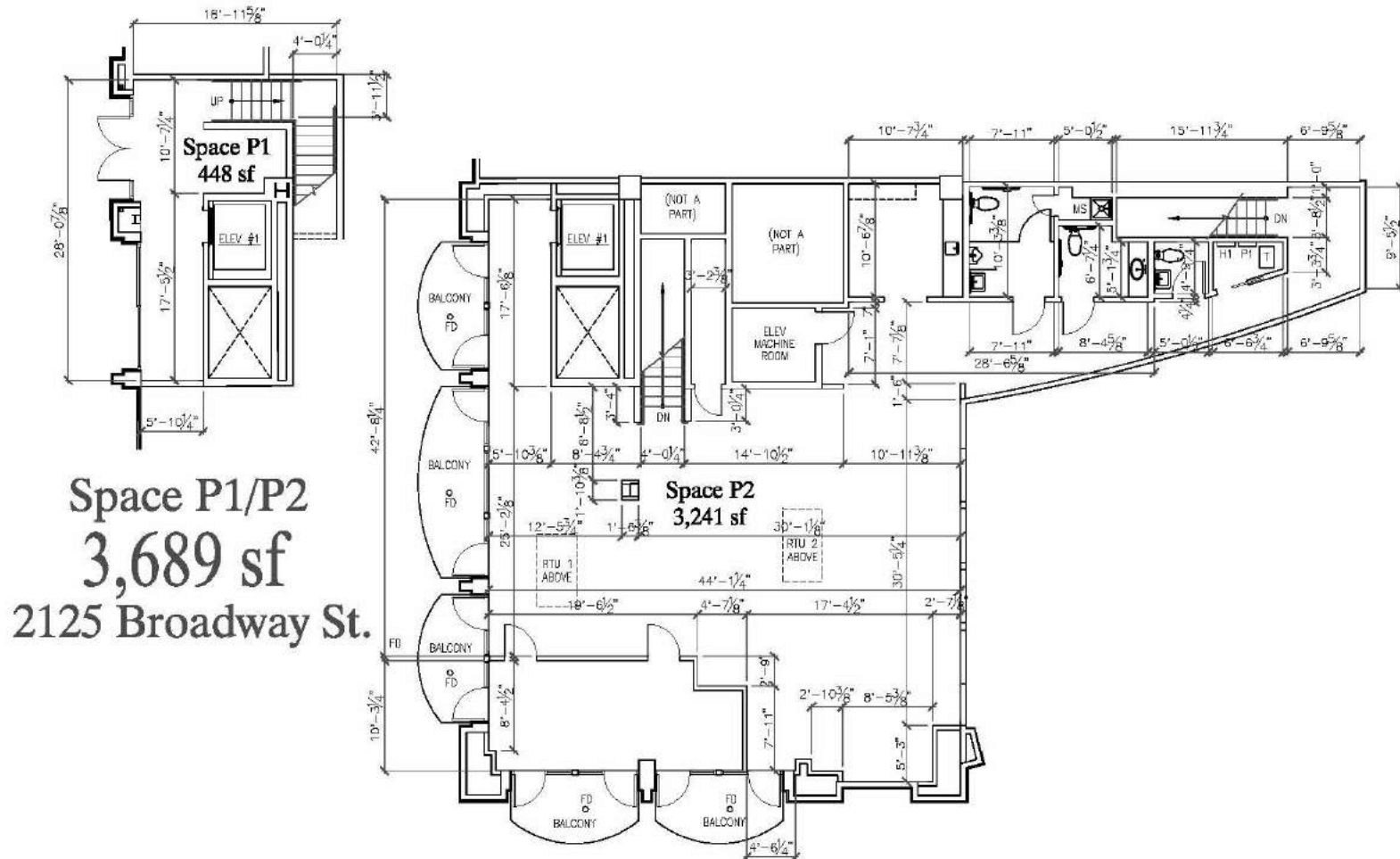

**ON BROADWAY SPACES P1/P2 - LEASE PLAN**  
REDWOOD CITY, CA January 22, 2018



Deutsche Asset  
& Wealth Management

**FOR LEASING INFORMATION:**  
Tom Klein & Courtney Jones  
Crosspoint Realty Services, Inc.  
280 California Street  
San Francisco, CA 94111  
[www.crosspointrealty.com](http://www.crosspointrealty.com)  
P: 415.288.6888 F: 415.258.6877

**DISCLAIMER:**  
THIS SITE PLAN IS INTENDED ONLY TO SHOW THE GENERAL LAYOUT OF THE PROPERTY OR A PART THEREOF. LANDLORD RESERVES THE RIGHT TO ALTER, VARY, ADD OR OMIT IN WHOLE OR IN PART ANY STRUCTURES, AND/OR IMPROVEMENTS, TENANT NAMES, STORE SIZES AND/OR LAND AREA SHOWN ON THIS PLAN. ALL MEASUREMENTS AND DISTANCES ARE APPROXIMATE. THIS PLAN IS NOT TO BE SCALED.

# On Broadway

## Jefferson Ave & Broadway | Redwood City, California

### MARKET AREA

#### On Broadway Tenants Include:

- |                     |                         |
|---------------------|-------------------------|
| Century Theaters 20 | Old Spaghetti Factory   |
| Powerhouse Gym      | Five Guys Burgers       |
| Vitality Bowl       | Cyclismo Cafe           |
| Yoho Yogurt         | Sola Salons             |
| Café Portabella     | Green Leaf Asian Bistro |
| Chipotle            | Timber & Salt           |
| Fish's Wild         | Go Health Urgent Care   |
| Pizza My Heart      |                         |

#### For information, contact:

**Courtney Jones**, CA BRE #01232209  
[cjones@crosspointrealty.com](mailto:cjones@crosspointrealty.com)

**Thomas N. Klein**, CA BRE #00840486  
[tklein@crosspointrealty.com](mailto:tklein@crosspointrealty.com)

Phone: 415-288-6888  
Fax: 415-288-6877

Crosspoint Realty Services, Inc.  
303 Sacramento Street, 3<sup>rd</sup> Floor  
San Francisco, CA 94111  
[www.crosspointrealty.com](http://www.crosspointrealty.com)

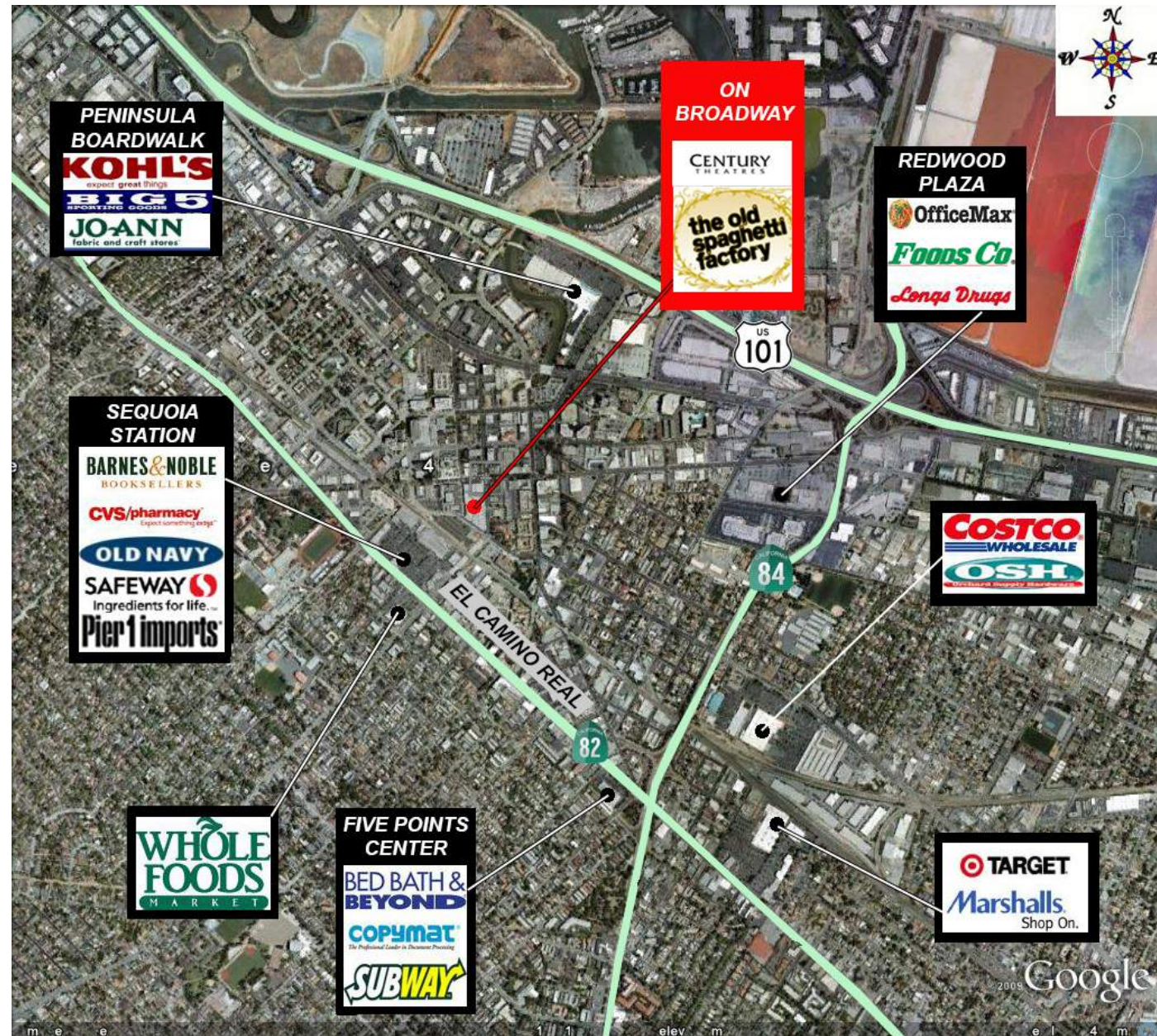

# On Broadway

## Jefferson Ave & Broadway | Redwood City , California

### MAP & INFORMATION

#### Description:

On Broadway is a 145,000 square foot entertainment retail center built in 2006 and anchored by a state of the art, 20 screen Century Theater complex. Jefferson Avenue is the main artery into downtown Redwood City from El Camino Real and Cost Plus anchors the Jefferson Avenue / Middlefield Road corner. Theater Way borders the north side of the project and includes various restaurants. The project also includes 585 easily accessible subterranean parking spaces.

#### Location:

Jefferson Avenue & Broadway Street, Redwood City, CA

#### For information, contact:

**Courtney Jones**, CA BRE #01232209  
[cjones@crosspointrealty.com](mailto:cjones@crosspointrealty.com)

**Thomas N. Klein**, CA BRE #00840486  
[tklein@crosspointrealty.com](mailto:tklein@crosspointrealty.com)

Phone: 415-288-6888  
Fax: 415-288-6877

Crosspoint Realty Services, Inc.  
303 Sacramento Street, 3<sup>rd</sup> Floor  
San Francisco, CA 94111  
[www.crosspointrealty.com](http://www.crosspointrealty.com)

